

04 FIRST FLOOR PLAN
SCALE-1:150

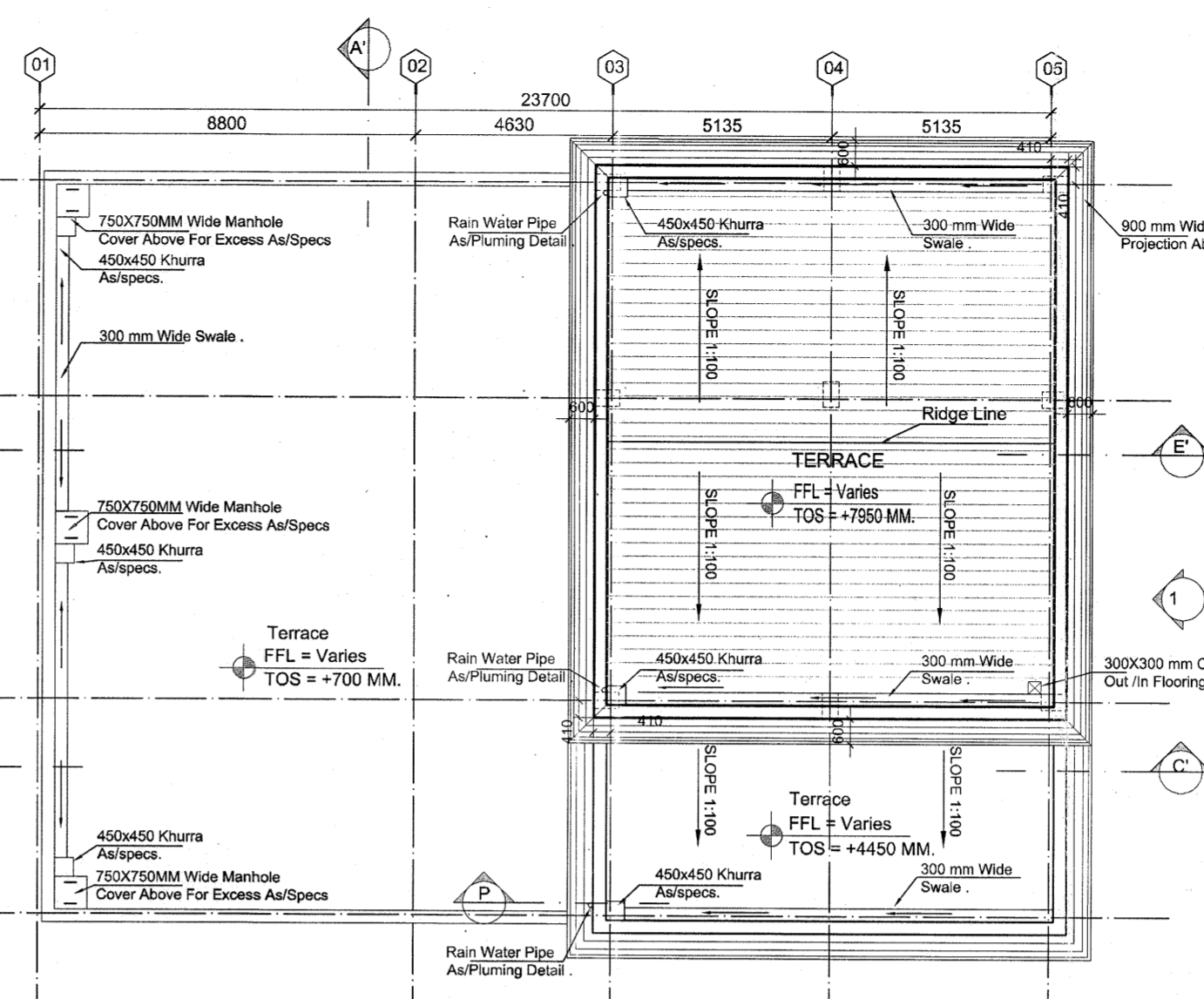

05 TERRACE PLAN
SCALE-1:150

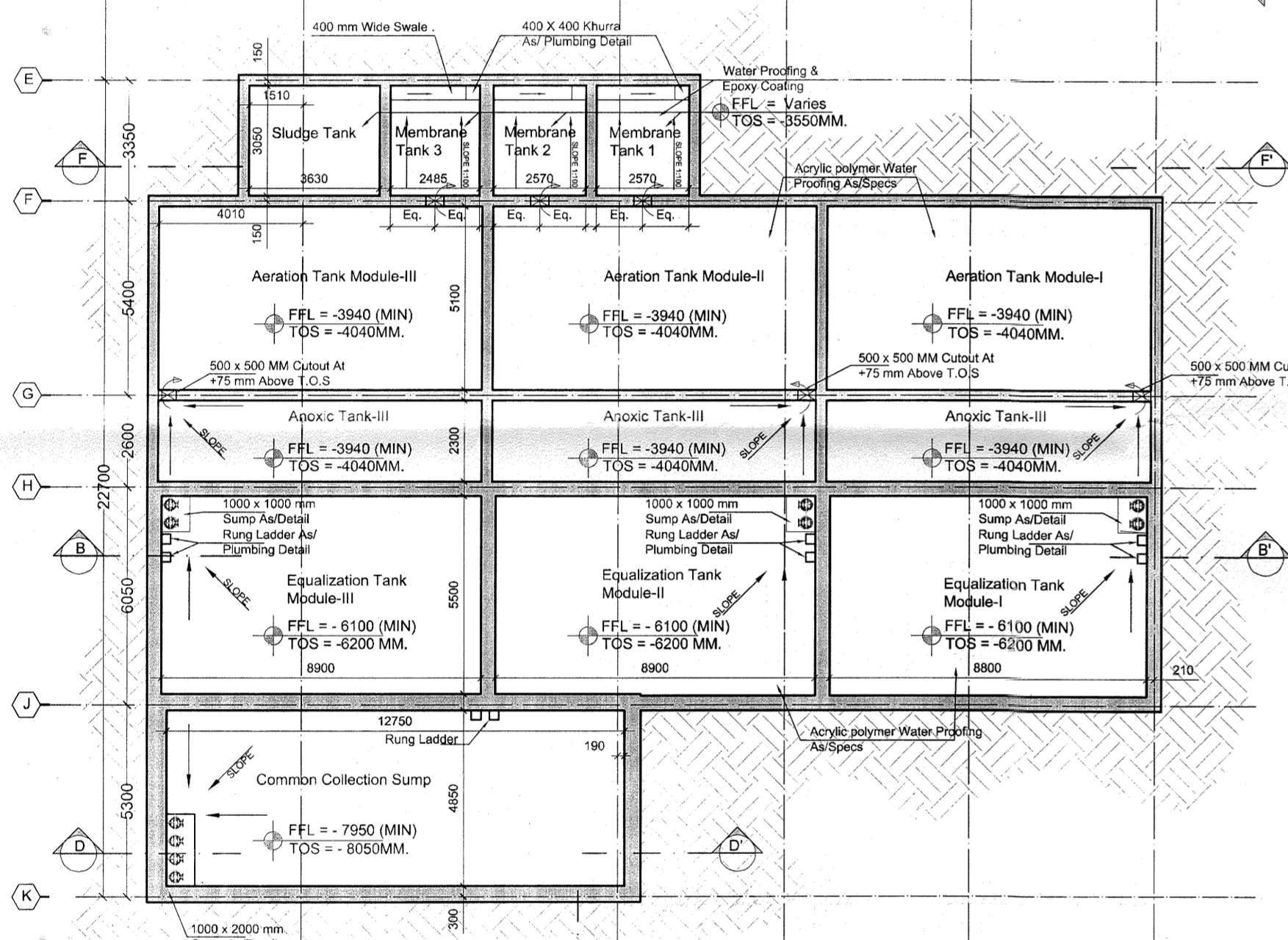

03 BASEMENT PLAN
SCALE-1:150

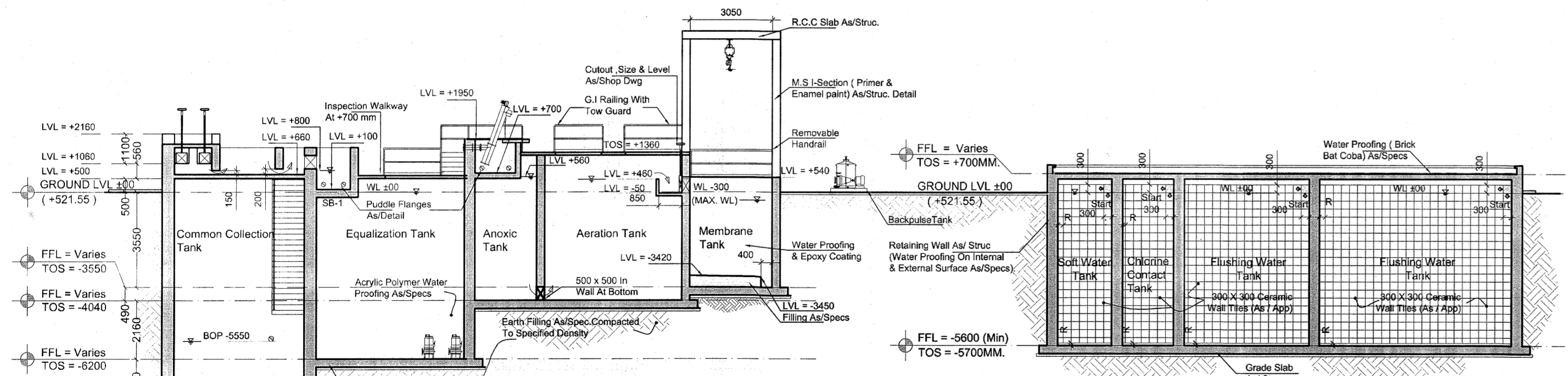

SECTION A-A'

06 SECTION AA'
SCALE-1:150

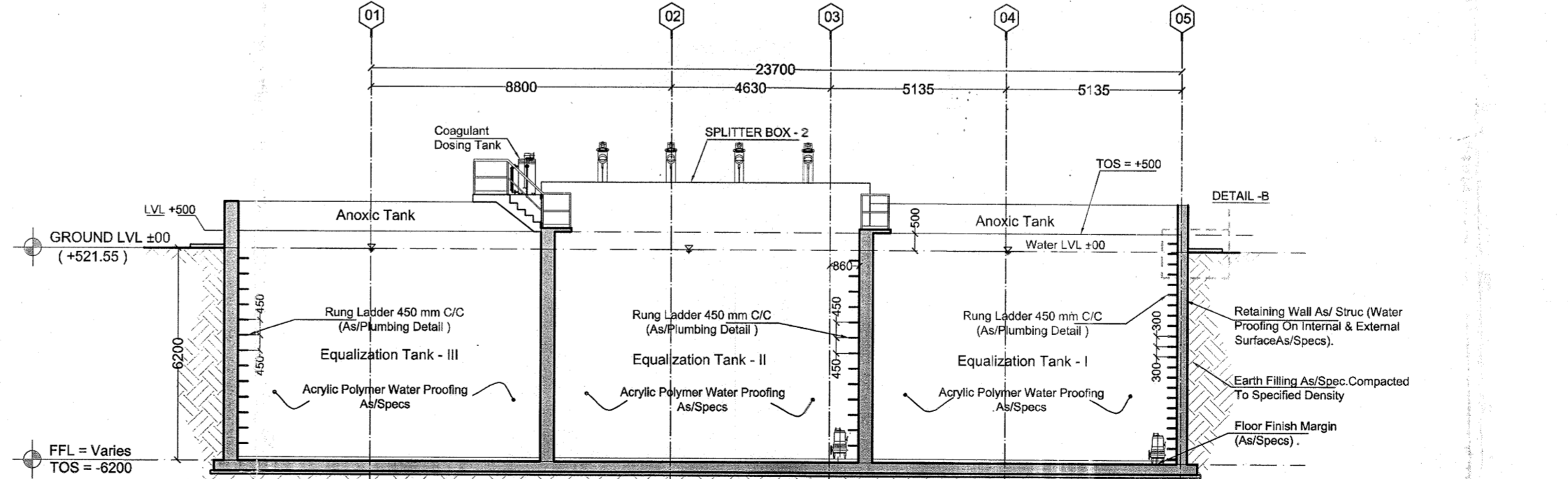

07 SECTION BB'
SCALE-1:150

- NOTES:**
- CONTRACTOR TO PREPARE DRAWING INDICATING FINAL PANEL SIZES ETC. & CO-ORDINATE WITH ELECTRICAL REQUIREMENTS & OBTAIN APPROVAL PRIOR TO CONSTRUCTION.
 - EXT. MASONRY WALLS ARE 200 THK. BLOCK WALLS AS PER SPECIFICATIONS.
 - ALL MASONRY WORK TO TERMINATE AT STRUCTURAL SOFFIT UNLESS MENTIONED.
 - REFER DETAILS SUBMITTED BY AAC BLOCK MANUFACTURER FOR NIBS & CORNERS & SQUIRTING CHARGES.
 - FOR FINISHES IN INDIVIDUAL ROOM, PLEASE REFER FINISHING SCHEDULE.
 - ALL FILLING IS LIGHT-WEIGHT (TO BE DONE AS / SPECIFICATION).
 - REPRESENTS THE CUTOUT IN FLOOR SLAB, FOR DIMENSIONS & LOCATION REFER RESPECTIVE DRAWINGS.
 - TYPICAL STRUCTURAL DETAILS FOR SUPPORTS TO BE FOLLOWED WHILE CASTING LINTEL & MASONRY WALL.
 - FOR ALL GLAZING/ ALUMINUM WORK PLEASE REFER DWG. NO. COM-AR-101
 - NIBS SHOWN AT MASONRY WORK ARE 100mm WIDE (UNLESS MENTIONED).
- LEGEND:**
- 200 MM A.C.C BLOCK WORK AS/SPECS.
 - COMPACT EARTH AS PER SPEC.

FINISHING SCHEDULE

S.NO.	DESIGNATION CODE	DESCRIPTION
1.	F1	INDUSTRIAL GRADE FLOORING (FOR HEAVY MACHINES) AS/SPECS.
2.	F2	POLISHED KOTA STONE FLOORING (AS/SPECS) OF APPROVED QUALITY, SIZE (650 X 550 MM) LAID AS / PATTERN & SPECIFICATION.
3.	F8	300 X 300 MM CERAMIC TILES FLOORING OF APPROVED QUALITY, SHADE, SIZE LAID AS/PATTERN AND AS/SPECIFICATION.

B. WALL

S.NO.	DESIGNATION CODE	DESCRIPTION
1.	W2	300 X 300 MM CERAMIC TILE CLADDING OF APPROVED SIZE, SHADE, LAID AS/PATTERN & SPECIFICATION.
2.	W3	PLASTER & PAINTED CONCRETE WALL AS/SPECS.

C. CEILING

S.NO.	DESIGNATION CODE	DESCRIPTION
1.	C1	CONCRETE ROOF, PLASTER & PAINTED AS/ SPECIFICATIONS.

DOOR WINDOW SCHEDULE

ROUGH OPENING						
S.no.	Window no.	Width	Height	Cill	Lintel	Remark
1.	W1	1200	1350	750	2100	OPENABLE WINDOW
2.	W2	1200	1350	750	2100	5 MM THK FLOAT FIXED GLASS WINDOW AT STRUC. BEAM SOFFIT

S.no.	Door no.	Width	Height	Cill	Lintel	Remark
1.	RS	3000	3345	-	2100	BEAM SOFFIT ROLLING SHUTTER
2.	D1	1500	2100	-	2100	METAL DOOR
3.	D2	1200	2100	-	2100	FLUSH DOOR
4.	D3	1000	2100	-	2100	FLUSH DOOR
5.	D4	750	2100	-	2100	FLUSH DOOR

S.no.	Door no.	Width	Height	Cill	Lintel	Remark
1.	L1	3000	600	6750	BEAM SOFFIT	LOUVER FOR FRESH AIR INTAKE

LEGEND FOR FLOORING

START PANEL	↑
RESIDUAL PANEL	'R'

S.no.	Plot no.	N.G.L.	Building external finish Lvl (±00)
1.		+520.50	+521.55

LEGEND:

S.NO.	SYMBOL	DESCRIPTION
1.	⊙	SMOKE DETECTOR
2.	⊠	28 W FLORESCENT TUBE LIGHT FIXTURE.
3.	⊙	36" CEILING FAN.
4.	⊕	SURFACE MOUNTED LIGHT

NOTES

- ALL M.S. ELEMENTS SHALL BE FINISHED WITH ZINC CHROMATE PRIMER & 2 COATS OF SYNTHETIC ENAMEL PAINT OF LOW V.O.C.
- ALL R.C.C. MEMBERS COMING IN CONTACT WITH SEWAGE SHALL BE COATED WITH 2 COATS OF EPOXY COATING.
- FOR VENTILATION - SUFFICIENT NOS. OF CEILING & EXHAUST FANS TO BE PROVIDED.
- FOOT REST TO BE PROVIDED INSIDE TANK FOR MAINTENANCE PURPOSE (AS/SPECS).
- HARDWARE FOR DOORS & WINDOWS TO BE AS/SPECIFICATIONS.
- INTERNAL FINISH:-
 - (a) FOR THE TANKS MEANT FOR SEWAGE COLLECTION = COAL TAR EPOXY.
 - (b) FOR THE TANKS MEANT FOR CLEAR WATER COLLECTION = CERAMIC TILES.

Key Plan:

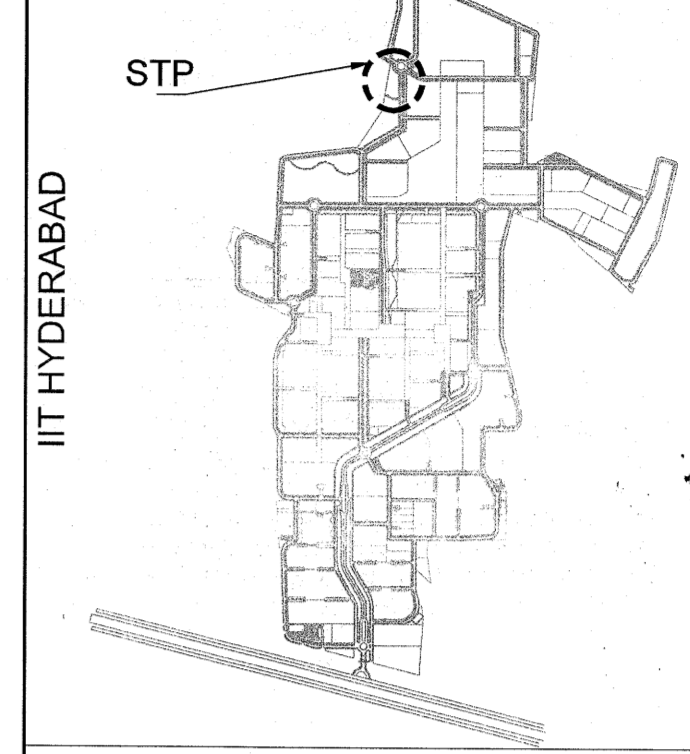

ISSUES

S. NO.	DATE	BY	TO	PURPOSE
1.	26-06-2014	ARCOP	SITE	GFC.

REVISIONS

- NOTES:**
- ACRYLIC POLYMER BASED WATER PROOFING OF APPROVED MAKE ON HORIZONTAL SURFACE (TOP OF R.C.C. LAID FOR BASE, PLINTH BEAMS) & ON VERTICAL SURFACES (BASEMENT RETAINING WALL EXTERNAL SURFACE, BEAM SIDES).
 - CRYSTALLINE WATER PROOFING TREATMENT TO BE DONE ON THE SURFACES OF WATER RETAINING STRUCTURES (ON HORIZONTAL & VERTICAL SURFACES BOTH).
 - BIRCHBAT COBA WATER PROOFING TO BE DONE ON TERRACE & REFERENCE VALUE OF ±00 CORRESPONDS TO +521.55 LEVEL AND N.G.L VALUE IS +520.50 LEVEL FOR THIS BUILDING.

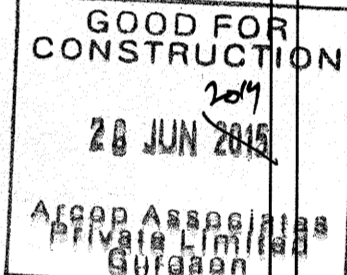

CLIENTS
Indian Institute of Technology (IIT) Hyderabad,
Ordnance Factory Estate,
Yeddumailaram-502205,
Andhra Pradesh, INDIA

ARCHITECTS & PLANNERS
ARCOP ASSOCIATES PVT. LTD.
E-106, G.K. ENCLAVE PART 1
NEW DELHI 110048
PHONE : 011 - 26242050
FAX : 011 - 26242035

Architect's Signature: *[Signature]*
Client's Signature: *[Signature]*
Executive Engineer (C), IITH.
16 JUL 2014

Job Title
IITH EXTERNAL SERVICES BUILDINGS

Drawing Title
MBR BASED SEWER TREATMENT PLANT

Document Release Type
ARCHITECTURAL GOOD FOR CONSTRUCTION

Job No.	2012/09	N
Scale	AS SPEC.	
Date	APR. 09. 2014	Drawing No.
Drawn by	JAI SAINI	STP-AR-02
Checked by	PANKAJ	Revision No.
AUTHORITY:		